



Specifications:

- Frequency: DC to 40 GHz
- 10dB attenuation
- Minimal change in attenuation with temperature
- Excellent RF Match
- Non-superconducting microstrip pad
- NiCr on crystal quartz dielectric
- Silver Epoxy bonded
- Machined OFHC block, gold plated
- 2.92mm connectors, non-magnetic
- Stackable mechanical design



Parameter	Specification	Notes
Frequency Range	DC to 40 GHz	
Insertion Loss variation with frequency	1dB typical	
Return Loss, all models	-13dB typical (-15dB typical, DC to 30 GHz)	See graph
Connectors	2.92mm (m-f)	
Max Power Handling	100 mW	

Made in the USA

✉ Sales@QuantumMicrowave.com

Measured Data (typical)

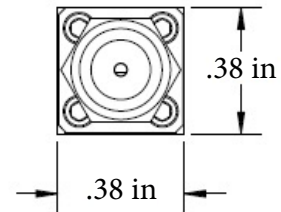
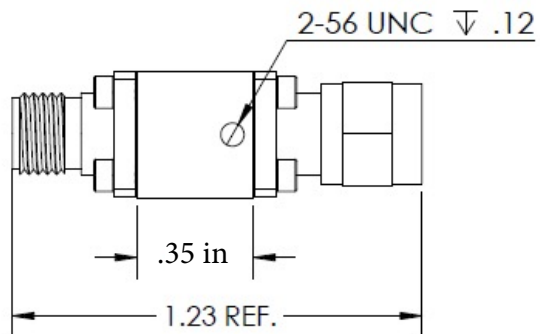
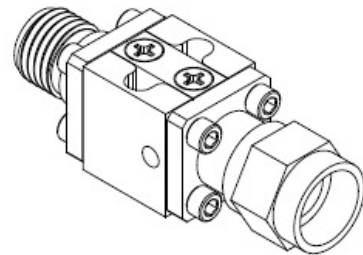
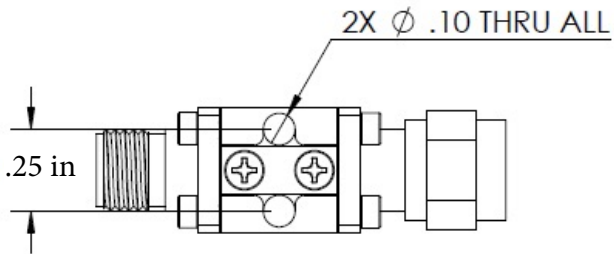
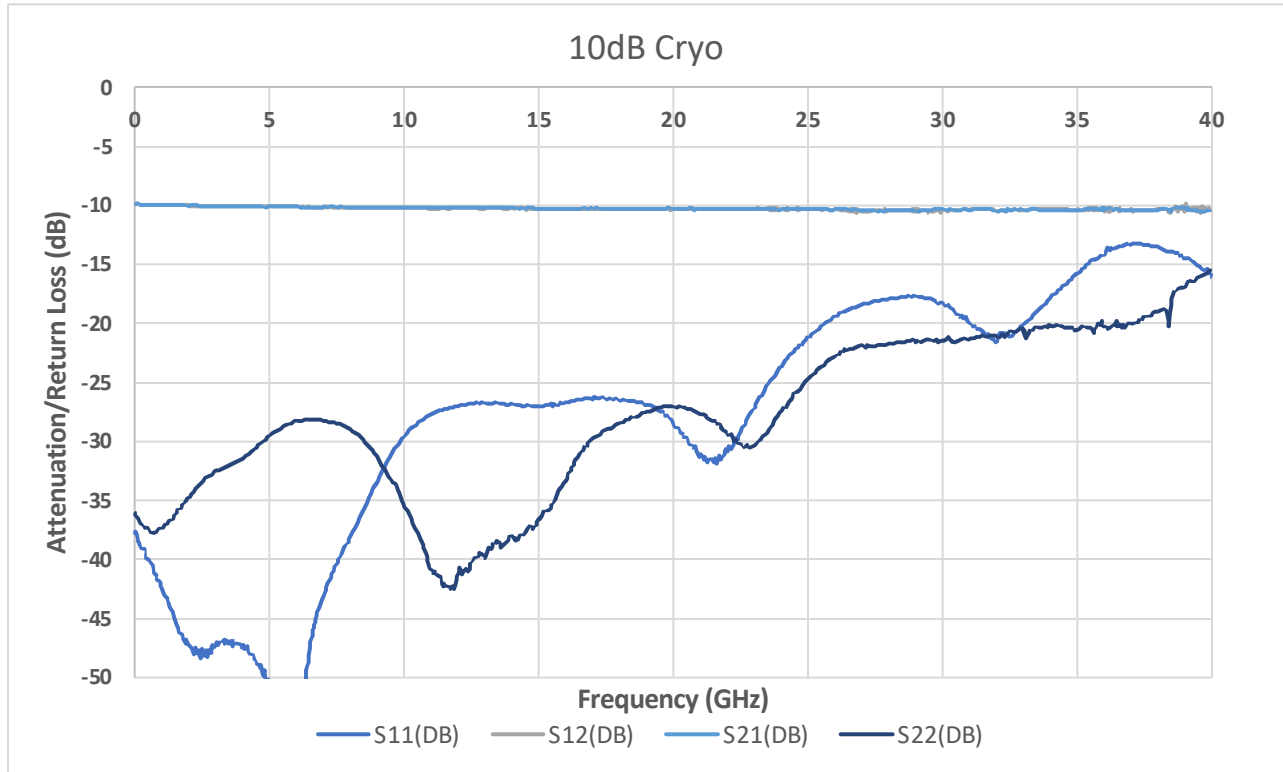

Made in the USA

✉ Sales@QuantumMicrowave.com