

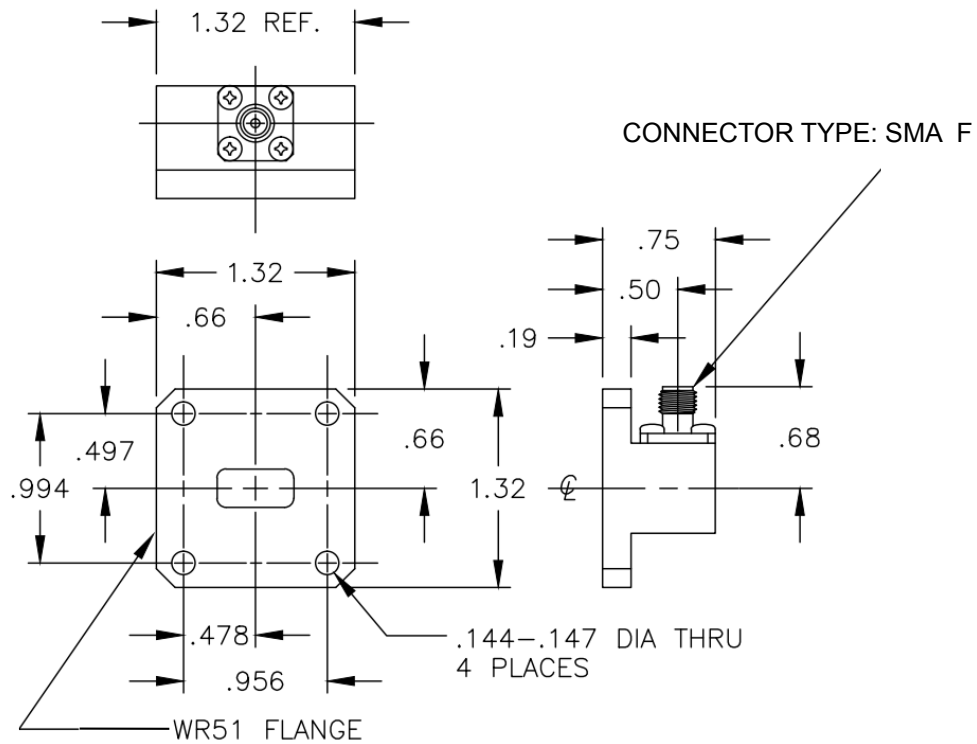

Specifications:

- WR-51 Waveguide to Coax Adapter
- Connector type: SMA Female
- Frequency: 15 to 22 GHz
- Insertion Loss: 0.1 dB typical
- VSWR: 1.20:1 Max
- Material: 6061-T6 Aluminum
- Finish: Chemical Film
- Waveguide: WR-51, Square



Made in the USA

✉ Sales@QuantumMicrowave.com