

www.QuantumMicrowave.com

Specifications:

- WR28 90 Degree E-Plane Bend
- Frequency: 26.5 to 40 GHz
- Length: 1 inch by 1 inch Flange to Flange
- WG In/Out: WR-28, UG-599/U Square Flange
- Material: Copper Waveguide
- Flanges: Brass
- Finish: Gold Plated



These waveguides are designed to have low loss and high performance
They are designed for low cost to save our customers money

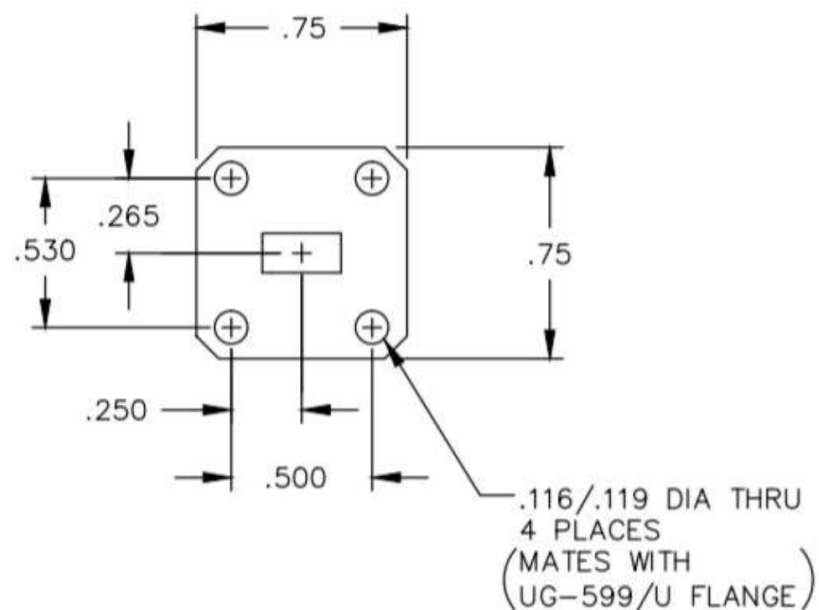

Made in the USA