

## 5.3 - 16 GHz Image Reject Mixer

P/N: QMC-IRM-0515UD

### Features

- 5.3 to 16 GHz RF/LO Down Converter
- Low Conversion Loss, 10 dB max
- LO Power: +8 dBm min
- SMA Female Connectors
- Gold Plated OFHC Housing
- IF: 20 to 100 MHz
- Reject Lower Sideband by 20 dB min
- Integrated IF Filter

Parameter	Specification	Notes
Frequency Range	5.3 GHz to 16 GHz	
Conversion Loss	10 dB max	See plot (Blue)
IF	20 to 100 MHz	
LO Power	+8 dBm min +9 dBm typical +13 dBm max	
Lower Sideband Image Reject	20 dB min	See plot (Yellow) RF < LO
LO to RF & RF/LO to IF isolation	-40 dBc min	

### Measured Data (typical response @ IF = 50 MHz)

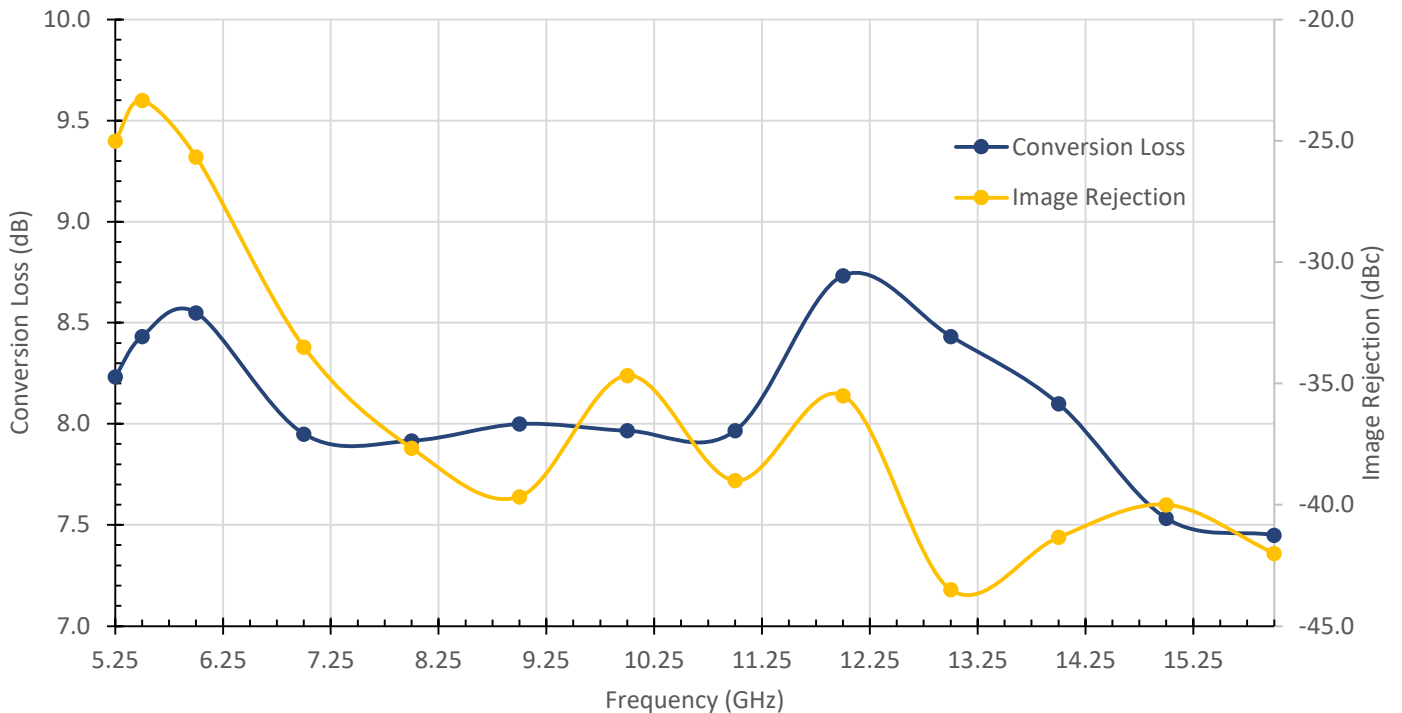

## Outline Drawing

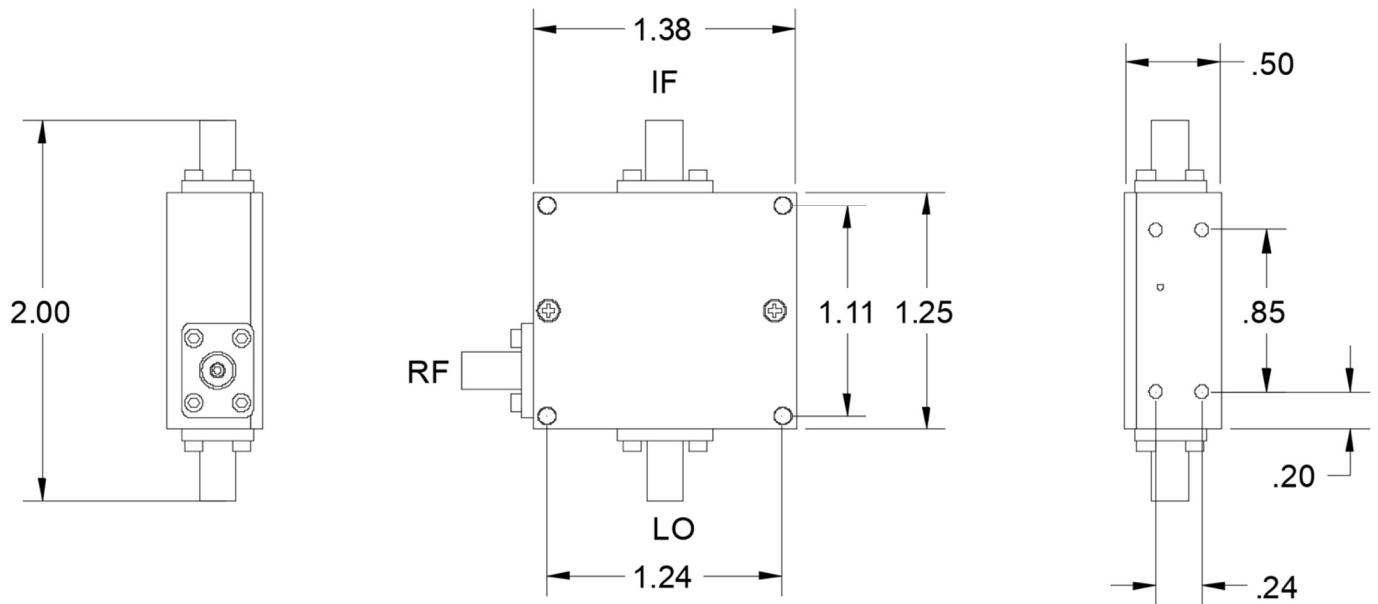

These IR mixers feature an integrated 90° hybrid and IF filtering to protect from LO to IF and RF to IF leakage. Each mixer is manufactured from high quality Oxygen-Free High thermal Conductivity (OFHC) copper for superior thermal performance in cryogenic applications. If upper sideband rejection is desired see part number: QMC-IRM-0515-LD